

PIN RECEPTACLES

**FOR .015" - .018" DIAMETER PINS (#09 CONTACT)
FOR .015" - .020" DIAMETER PINS (#11 CONTACT)
AND .015" - .022" DIAMETER PINS (#21 CONTACT)**

0467

0467-0-15-XX-21-XX-04-0

Press-fit in .037 mounting hole

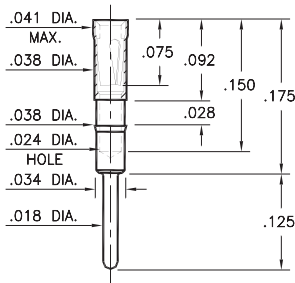

0552

0552-X-15-XX-X1-XX-10-0

Solder mount in .040 min. mounting hole
Also available on 16mm wide carrier tape:
1,500 parts per 13" reel

Order as: 0552-X-57-XX-X1-XX-10-0

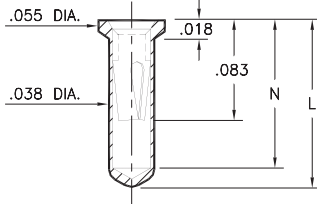

| Basic Part Number | Length L | Depth N |
|-------------------|----------|---------|
| 0552-1 | .136 | .120 |
| 0552-2 | .170 | .150 |

5522

5522-0-15-XX-09-XX-10-0

Solder mount in .040 min. mounting hole

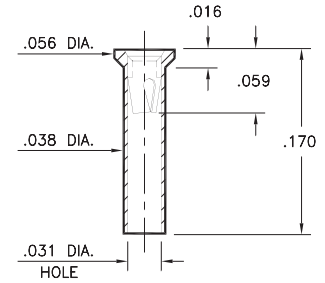

0569

0569-0-15-XX-X1-XX-10-0

Solder mount in .040 min. mounting hole
Also available on 16mm wide carrier tape:
2,000 parts per 13" reel
Order as: 0569-0-57-XX-X1-XX-10-0

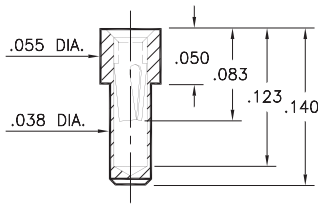

6023

6023-0-15-XX-21-XX-10-0

Solder mount in .040 min. mounting hole

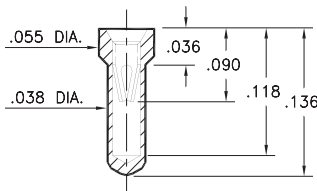

6214

6214-0-15-XX-21-XX-10-0

Solder mount in .040 min. mounting hole

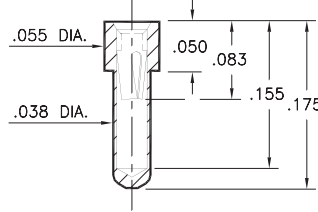

2086

2086-0-15-XX-21-XX-04-0

Press-fit in .040 mounting hole

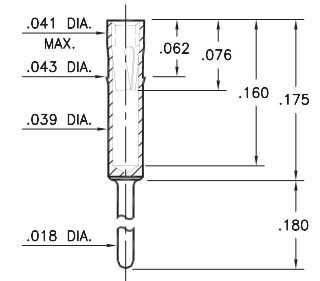

0461

0461-X-15-XX-X1-XX-04-0

Solder mount in .020 min. mounting hole

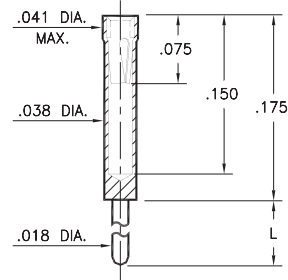

| Basic Part Number | Length L |
|-------------------|----------|
| 0461-0 | .400 |
| 0461-1 | .275 |
| 0461-2 | .180 |
| 0461-3 | .125 |
| 0461-4 | .060 |
| 0461-5 | .440 |

8579

8579-X-15-XX-X1-XX-10-0

Solder mount in .040 min. mounting hole
Also available on 24mm wide carrier tape:
1,200 parts per 13" reel
Order as: 8579-0-57-XX-X1-XX-10-0

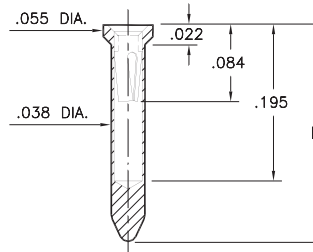

| Basic Part Number | Length L |
|-------------------|----------|
| 8579-0 | .234 |
| 8579-1 | .295 |

SPECIFICATIONS:

Shell Material: Brass Alloy 360, 1/2 Hard

Contact Material: Beryllium Copper Alloy 172, HT

Dimensions: Inches

Tolerances On: Lengths: ±.005

Diameters: ±.002

Angles: ±2°



ORDER CODE: XXXX - X - XX - XX - XX - XX - XX - 0

BASIC PART #

SPECIFY SHELL FINISH:

- 01 200 μ" TIN/LEAD OVER NICKEL
- ◆ 80 200 μ" TIN OVER NICKEL (RoHS)
- ◆ 15 10 μ" GOLD OVER NICKEL (RoHS)

SPECIFY CONTACT FINISH:

- 02 100 μ" TIN/LEAD OVER NICKEL
- ◆ 84 100 μ" TIN OVER NICKEL (RoHS)
- ◆ 27 30 μ" GOLD OVER NICKEL (RoHS)

SELECT CONTACT:

#09, #11 or #21 CONTACT (DATA ON PAGES 250 & 251)

(For alternate contact choices, see group A on page 248)

